

METAMORPH 9. INTERNATIONAL ARCHITECTURE EXHIBITION TRAJECTORIES

Marsilio



la Biennale di Venezia

**CLAUS EN KAAN ARCHITECTEN > OPERA HOUSE,
GHENT, BELGIUM, COMPETITION, 2004**

The site of the new theatre has been gradually chiselled out by the ever expanding and changing city and by the Schelde River. Ghent's capricious nature determines the character of this location. The spatial structure of our design consists of three parts: the envelope, the theatre room and the intervening landscape. The shape of the envelope originates in the organic characteristics of the location. The outer walls are made of glass. The main quality of the glass is not transparency, but reflection. The degree of transparency is determined by the various functions. This gives a visual edge to the programme in the urban landscape. The reflection of daylight will cover the building with a golden glow, achieved by the materialization of the skin. The glass is a durable varnish.

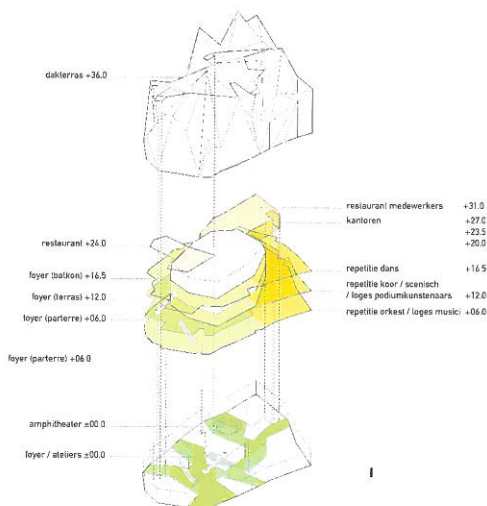
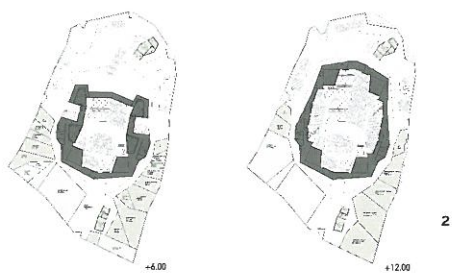

1 Functional scheme.
2 Plan.
3 Rendering.